



SINCE 1945
KEYSTONE
LIGHT MADE EASY

S SMART
CURRENT

CONSTANT CURRENT PROGRAMMABLE LED DRIVERS





CONSTANT CURRENT PROGRAMMABLE LED DRIVERS

EC&M Product of the Year 2018 Category Winner

PRODUCT FEATURES

- Programmable output current via Keystone's SmartCurrent cradle (KTLD-SC-PGMR-1)
• Meets FCC Part 15 (Class B) consumer limits
• Short circuit overload and open load protection
• Dimmable with 0-10V dimmer (down to 1% at max. output current)
• Auxiliary power: 12Vdc; 200mA max.



PROGRAMMING FEATURES

- Drive current (10 mA increments)
• Minimum dimming level (1%, 3%, 5%, 7%, or 10%)
• Dimming curve (linear, log, inverse log, or square-log)
• Minimum dimming voltage (1V, 1.5V, or 2V)
• Maximum dimming voltage (7V, 8V, or 9V)
• Dim-to-off voltage (0.8V, 1V, 1.2V, or N/A)
• Thermal foldback temperature (75°C/167°F, 80°C/176°F, 85°C/185°F, or 90°C/194°F)



SmartCurrent Cradle

Catalog No. KTLD-SC-PGMR-1

Programming the driver is easy with the SmartCurrent Cradle. The cradle connects the driver to the SmartCurrent PC software via USB (cable included). Start by downloading the SmartCurrent PC software from KeystoneTech.com. Then use the software to program the driver to your specifications.

ACCESSORIES

Table with 2 columns: Catalog Number, Description. Rows include KTLD-SC-PGMR-1 (SmartCurrent Cradle), KTLD-SC-ADPT-1A (Programming jig adapter for U7 and U4 case drivers), and KTLD-SC-ADPT-1B (Programming jig adapter for W1 case drivers).

WHAT'S NEEDED?

A SmartCurrent Programmable LED Driver, the SmartCurrent Cradle, and a computer.



ENVIRONMENTAL SPECIFICATIONS

Table with 2 columns: Specification, Value. Rows include Operating Temperature (-20°C/-4°F to 50°C/122°F), Storage Temperature (-40°C/-40°F to 85°C/185°F), Humidity (5% to 95%), Life Rating (85,000 hours at 120Vac input, 100% load and 60°C case temperature), and Maximum Case Temperature (90°C/194°F).

ELECTRICAL SPECIFICATIONS

Input Voltage Range	120-277Vac ±10%
Frequency	50/60 Hz
Power Factor	>0.9 under 120~277Vac input with 80~100% load condition (for all output currents)
THD	< 20% under 120~277Vac input with 80~100% load condition (for all output currents)
No Load Power Consumption	< 2W
Protection	<ul style="list-style-type: none"> • Over Voltage Protection: Hiccup mode. Protection will trigger when load voltage exceeds specified output voltage and will auto recover after the fault mode is removed. • Over Current Protection: Hiccup mode. Protection will trigger when load current exceeds specified output current and will auto recover after the fault mode is removed. • Short Circuit Protection: Hiccup mode. Protection will trigger when short circuit occurs and will auto recover after the fault mode is removed. • Over Temperature Protection: Protection will trigger when driver overheats and auto-recover when cooled down.

PRODUCT SPECIFICATIONS

Catalog Number	Max. Output Power	Max. Input Current	Output Current	Output Voltage	OCV	Typical Efficiency at 120V	Typical Efficiency at 240V	Typical Efficiency at 277V	Remote Mounting Distance (#18 AWG)	Class 2	
										US	CAN
KTLD-25-UV-SC1250-56-VDIM-W1	25W	0.28A @120V 0.16A @240V 0.13A @277V	420-1250mA	10-56V	60V	86%*	86%*	86%*	29 ft.	Yes	No
KTLD-30-UV-SC1050-56-VDIM-U7	30W	0.31A @120V 0.17A @240V 0.15A @277V	350-1050mA	10-56V	60V	87%	86%	86%	35 ft.	Yes	No
KTLD-40-UV-SC1400-56-VDIM-W1	40W	0.49A @120V 0.24A @240V 0.22A @277V	470-1400mA	10-56V	60V	86%*	86%*	86%*	26 ft.	Yes	No
KTLD-50-UV-SC1400-56-VDIM-U7	50W	0.52A @120V 0.28A @240V 0.24A @277V	470-1400mA	10-56V	60V	87%	87%	87%	26 ft.	Yes	No
KTLD-85-UV-SC2600-56-VDIM-U4	85W	0.89A @120V 0.44A @240V 0.38A @277V	860-2600mA	10-56V	60V	86%	88%	88%	24 ft.	Yes	No

*preliminary

LED DRIVER OUTPUT WINDOW

25W

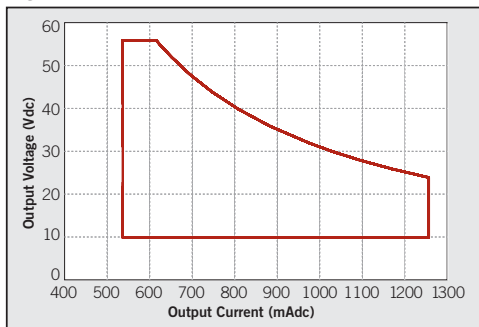

Note: Driver is in Constant Power mode from 540mA to 1250mA.

30W

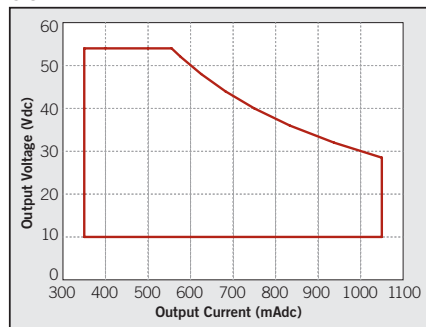

Note: Driver is in Constant Power mode from 550mA to 1050mA.

40W

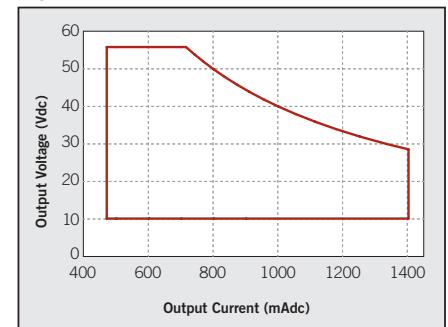

Note: Driver is in Constant Power mode from 720mA to 1400mA.

50W

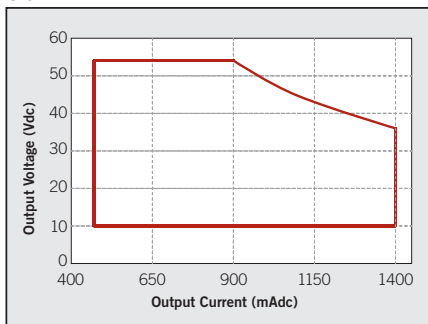

Note: Driver is in Constant Power mode from 900mA to 1400mA.

85W

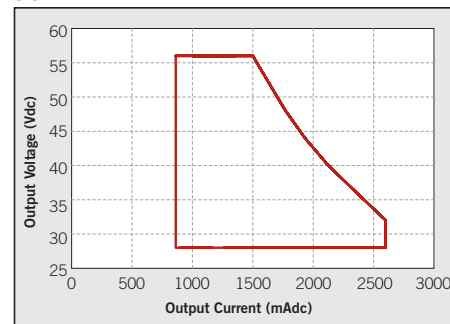

Note: Driver is in Constant Power mode from 1500mA to 2600mA.

SAFETY AND EMC COMPLIANCE

UL/cUL	UL 8750
CE	EN61347-1, EN61347-2-13
FCC, 47CFR Part 15	ANSI C63.4:2009 Class B (Consumer Limit)
EN61000-3-2	Harmonic Current Emissions Class C

PHYSICAL SPECIFICATIONS

U Case Style

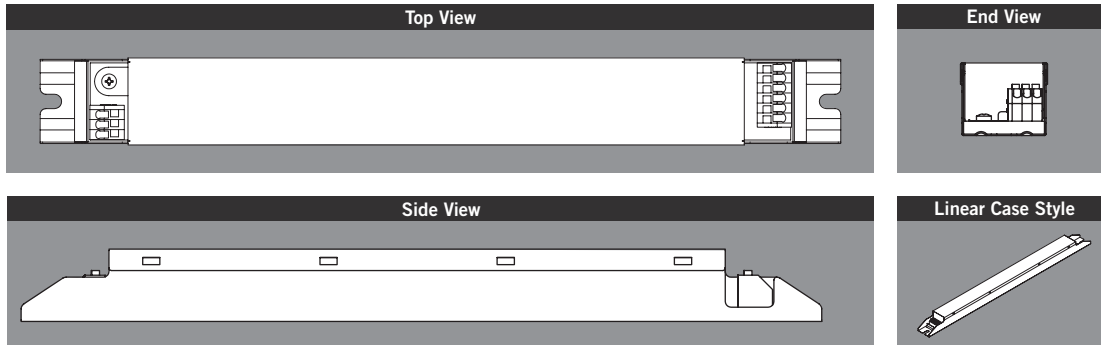

Wattage	Case Style	Length	Width	Height	Mounting	Case Material
30W	U7	11.02"	1.20"	1.00"	10.63"	Metal
50W	U7	11.02"	1.20"	1.00"	10.63"	Metal
85W	U4	16.89"	1.18"	1.00"	16.02"	Metal

W Case Style

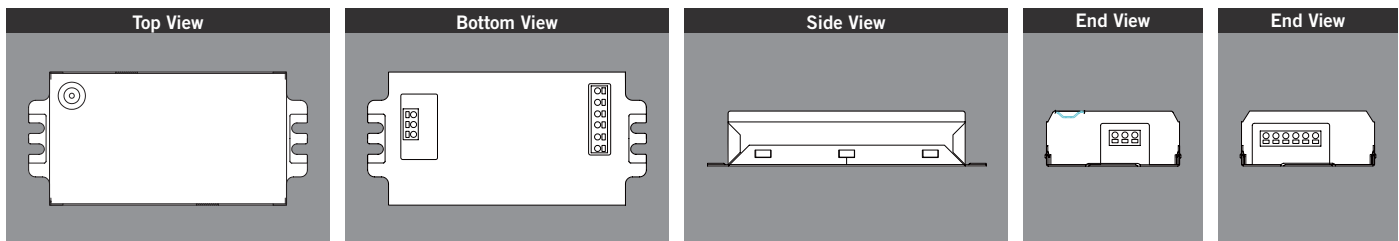

Wattage	Case Style	Length	Width	Height	Mounting	Case Material
25W	W1	5.00"	2.40"	1.00"	4.63"	Metal
40W	W1	5.00"	2.40"	1.00"	4.63"	Metal

Drivers are available for pre-programming before shipment. Order with /pp at the end of the catalog number and list the desired output current setting on the purchase order. Example: KTLD-30-UV-SC1050-56-VDIM-U7 /pp

