



PAR38 COMMERCIAL REPLACEMENT LAMPS

INSTALLATION INSTRUCTIONS

IMPORTANT SAFEGUARDS

When using electrical equipment, basic safety precautions should always be followed including:

READ AND FOLLOW ALL SAFETY INSTRUCTIONS

WARNING: Risk of fire or electric shock. LED retrofit lamp installation requires knowledge of luminaire electrical systems. If not qualified, do not attempt installation. Contact Keystone Technologies. Installation should be performed only by a qualified electrician in accordance with the National Electrical Code and relevant local codes and regulations.

WARNING: Risk of fire or electric shock. Install this lamp only in luminaires that have the construction features and dimensions written and shown in the illustrations or where the input rating of the retrofit lamp does not exceed the input rating of luminaire.

CAUTION: If the lamp or luminaire exhibits undesirable operation (buzzing, flickering, etc.), immediately turn off power, remove lamp from luminaire, and contact Keystone Technologies.

- Disconnect power at the source before installation, inspection, or removal. Do not simply switch off fixture.
- This item is rated at 120–277V. Installer must determine whether line voltage of 120–277V is available at the luminaire before installation.
- Not intended for use with emergency exit fixtures or emergency exit lights.
- Not for use with luminaire ballast.
- Do not use if product is damaged.
- This lamp is non-dimmable. Not for use with dimmer.
- Do not make or alter any open holes in an enclosure of wiring or electrical components during lamp installation.
- “This luminaire has been modified to operate LED lamps” shall be marked on the luminaire where readily visible by the user during normal maintenance including re-lamping.
- Risk of fire or electric shock. Do not open or modify. No user serviceable parts inside.
- Installers should not disconnect existing wires from lamp holder terminals to make new connections at lamp holder terminals; instead, installers should cut existing lamp holder leads away from the lamp holder and make new electrical connections to lamp holder lead wires by employing applicable connections.
- Suitable for dry and damp locations. Not for use where directly exposed to the water.
- Complies with part 15 of FCC. Operation is subject to the following two conditions:
 - This device must not cause harmful interference;
 - This devices must accept any interference received including interference that may cause undesired operation.
- No external weight or mechanical force should be applied to lamp or components.
- The retrofit lamp assembly is accepted as a component of a luminaire where the suitability of the combination shall be determined by UL or authorities having jurisdiction.

SAVE THESE INSTRUCTIONS

INSTALLATION INSTRUCTIONS

RETROFIT WITH NO BALLAST

1. Turn off AC power electricity to the fixture.
2. Unscrew and remove the lamp from the light socket.

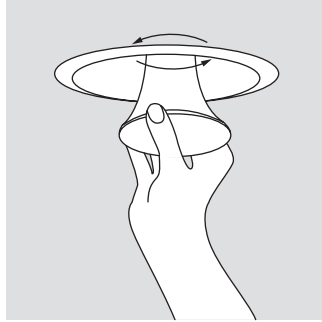

3. Screw Keystone PAR38 lamp into the socket.

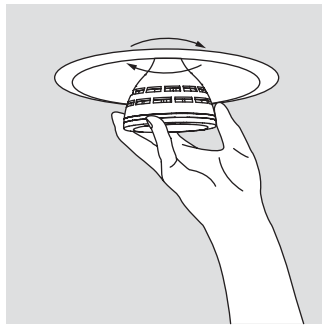

4. Turn on AC power electricity to the fixture.

RETROFIT WITH EXISTING BALLAST REMOVAL

1. Turn off AC power electricity to the fixture.
2. Unscrew and remove existing HID lamp from the light socket and screw in PAR38 lamp.

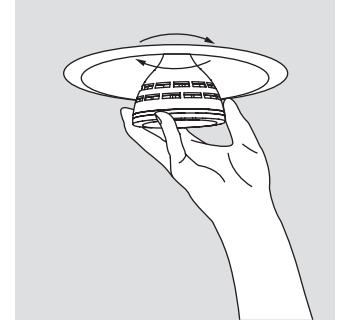
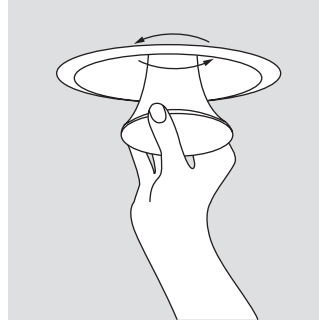

3. Open the fixture's junction box and bypass the HID ballast, ignitor (if there), and capacitor (if there)—shown by Xs in the illustration below—and connect the line and neutral wires directly to the socket black and white wires.

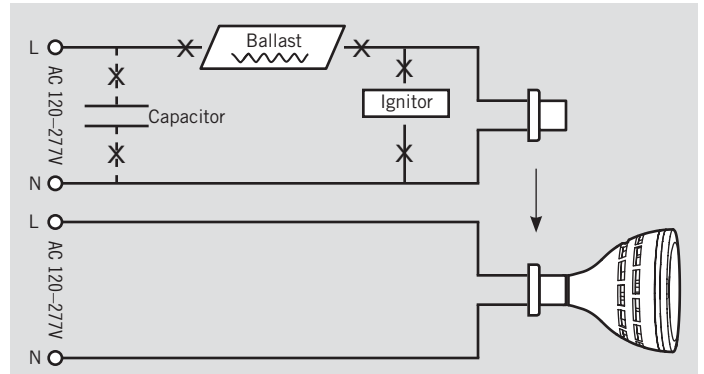

4. Close the fixture's junction box.
5. Clean the area before applying the re-lamp warning label to a visible location on the fixture.
6. Turn on AC power electricity to the fixture.

SAVE THESE INSTRUCTIONS